

Setup Instructions:

- 1) Use screw caps to secure the side panels to front panel and back panels.
- 2) Place internal shelf onto panel supports.
- 3) Attach pedestal top to assembled pedestal base. See [Pedestal Top Attachment](#) detail.

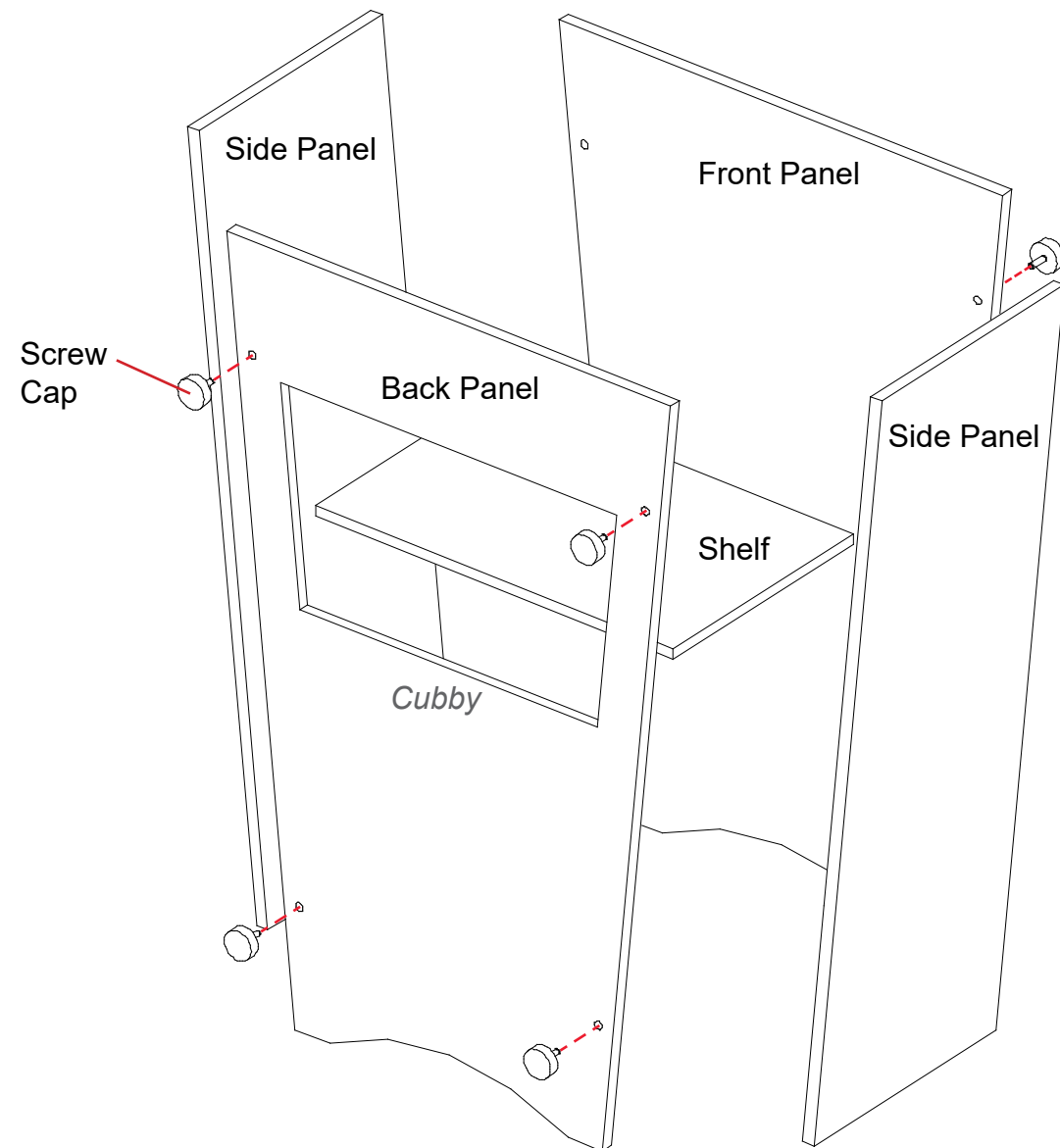

Pedestal Base Assembly

BACK VIEW

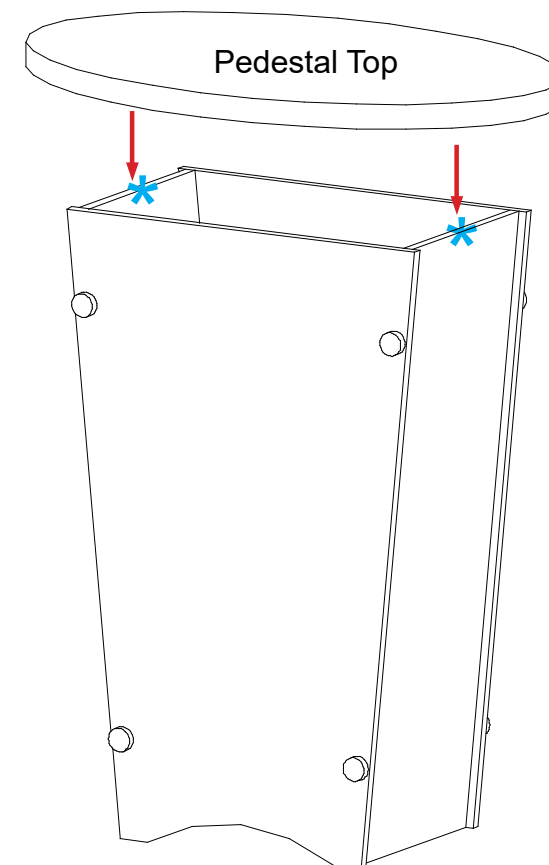

Pedestal Top Attachment

FRONT VIEW

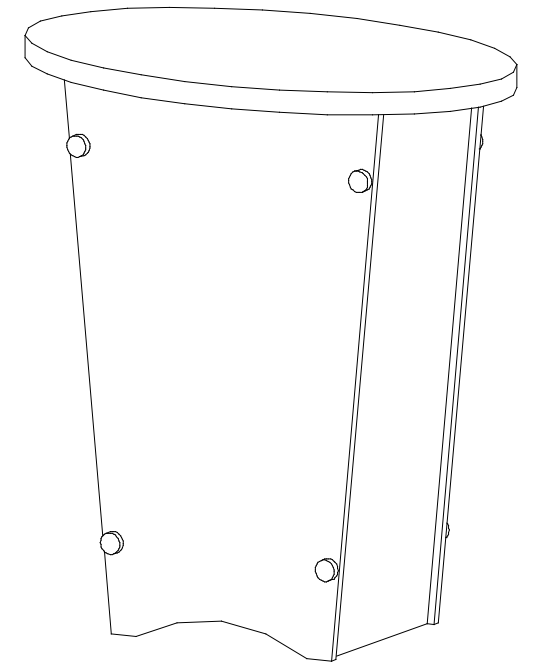

Completed Pedestal Assembly

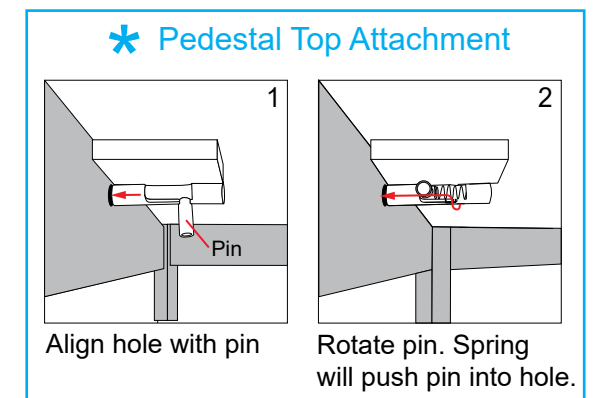

# SETUP INSTRUCTIONS

Top View of Each Level

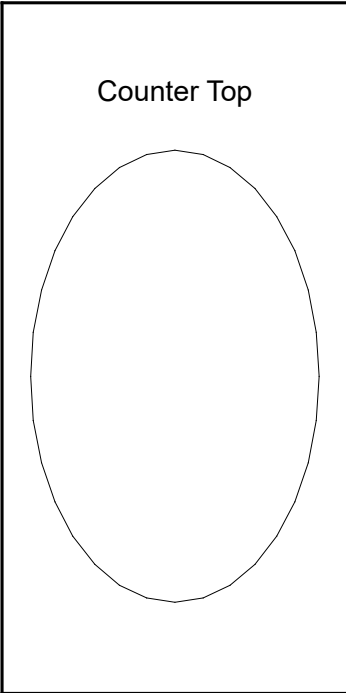

Level 1  
(Bottom level)

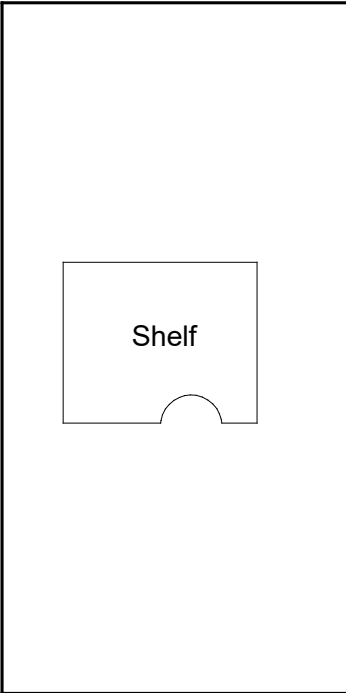

Level 2

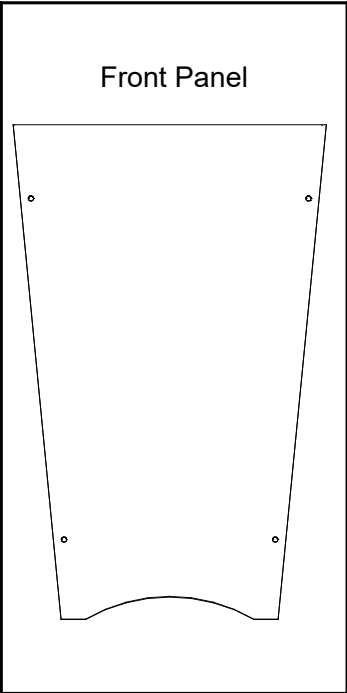

Level 3

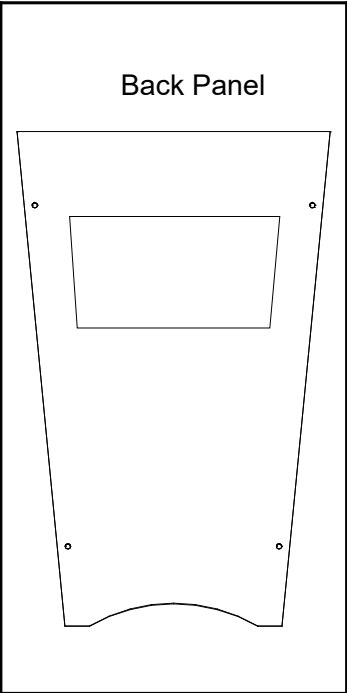

Level 4

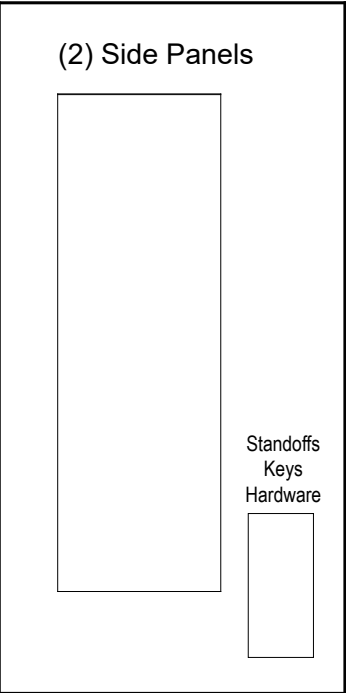

Level 5